

SCHLOSSPARK
FREIHOF

Living at Schlosspark Freihof
Part EAST
Ground Floor - Top 02.01a-Variant

Living Space Ground F.	137.88 m ²
Terrace	70.15 m ²
Garden	138.32 m ²
Room height=approx. 2.65 m	

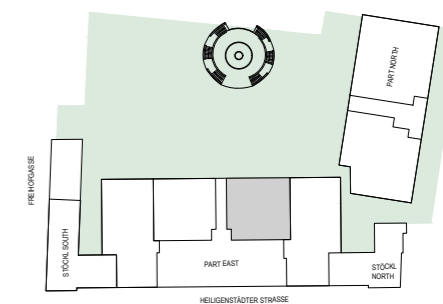

www.schlossparkfreihof.at
office@schlossparkfreihof.at

A project by **SORAVIA**

Plan status 3/2024. Non-binding plan copy. Subject to change without notice. The furniture shown is not part of the scope of delivery and serves only as a furnishing suggestion. All items shown are of a symbolic nature. The dimensions shown in this plan are rough dimensions and cannot be used for ordering built-in furniture—natural dimensions required! Room and apartment sizes and room heights may change slightly if necessary.

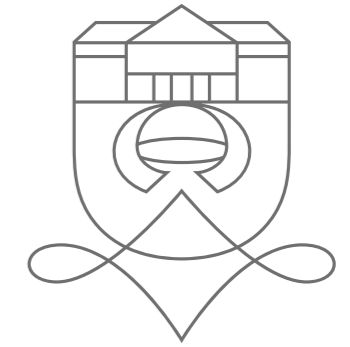
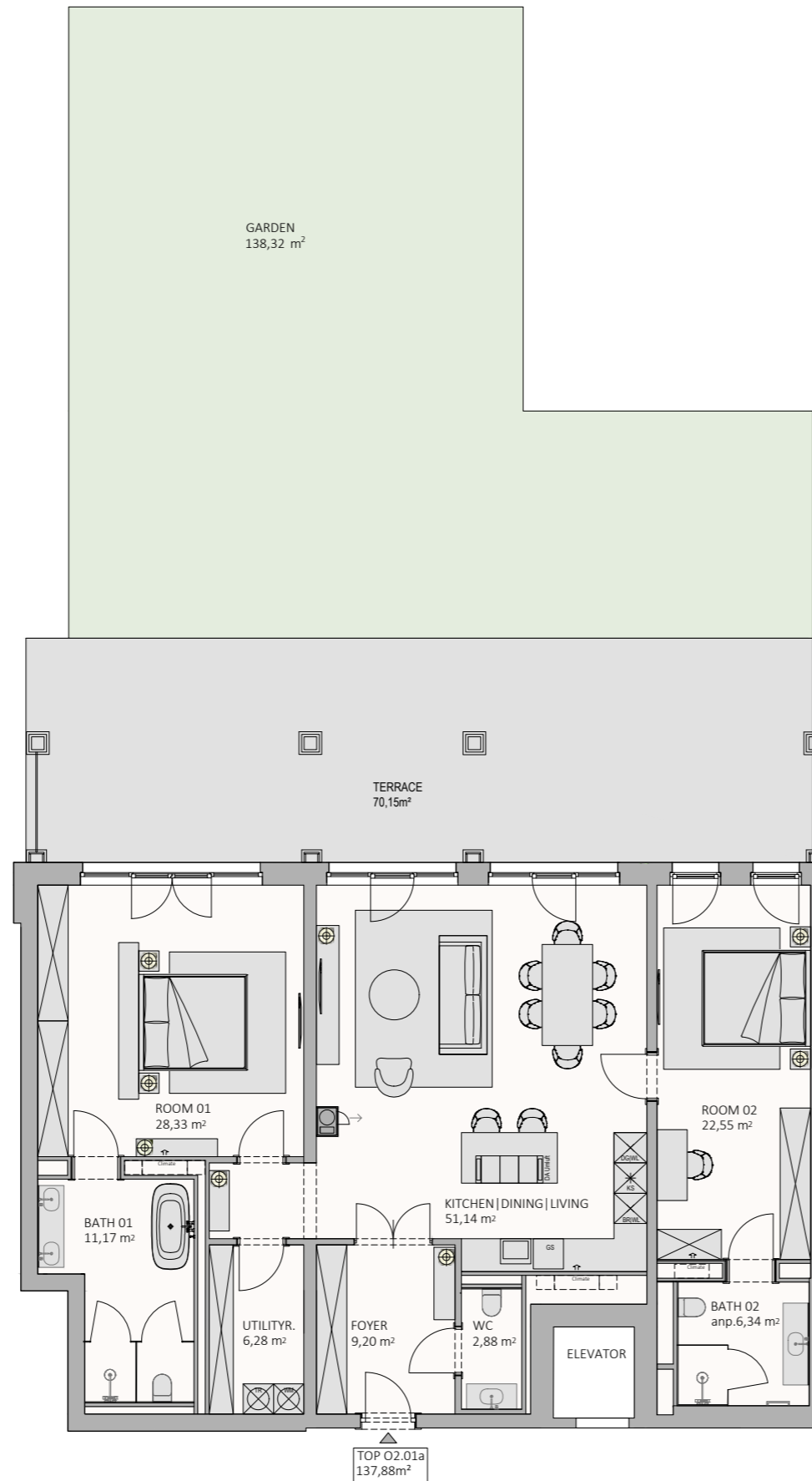

SCHLOSSPARK
FREIHOF

Living at Schlosspark Freihof
Part EAST
Ground Floor - Top 02.01a-Variant

Living Space Ground F.	137.88 m ²
Terrace	70.15 m ²
Garden	138.32 m ²
Room height=approx. 2.65 m	

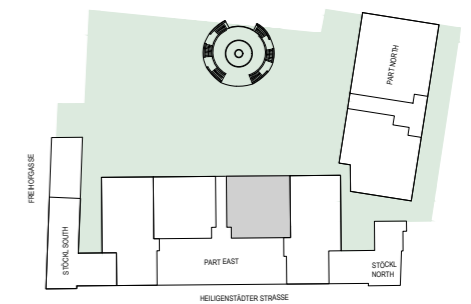

Plan status 3/2024. Non-binding plan copy. Subject to change without notice. The furniture shown is not part of the scope of delivery and serves only as a furnishing suggestion. All items shown are of a symbolic nature. The dimensions shown in this plan are rough dimensions and cannot be used for ordering built-in furniture—natural dimensions required! Room and apartment sizes and room heights may change slightly if necessary.

www.schlossparkfreihof.at
office@schlossparkfreihof.at

A project by **SORAVIA**